

## Type:SDR63B

### ◆ Product Description

- 6.5×5.9mm Max.(L×W),3.5mm Max. Height.
- Inductance Range: 10~100μH
- Rated current range: 0.42~1.0A
- In addition to the standards versions shown here, custom inductors are also available to meet your exact requirements.

### ◆ Feature

- Magnetically shielded construction.
- Ideally used in Notebook PC,LCD TV,HDD,Game machine,DSC/DVC,etc as DC-DC Converter inductors.
- RoHS Compliance.

### ◆ Application

- Notebook PC
- HDD
- Game machine
- DSC/DVC
- LCD TV
- DC/DC converters, etc

### ◆ Dimensions(mm)

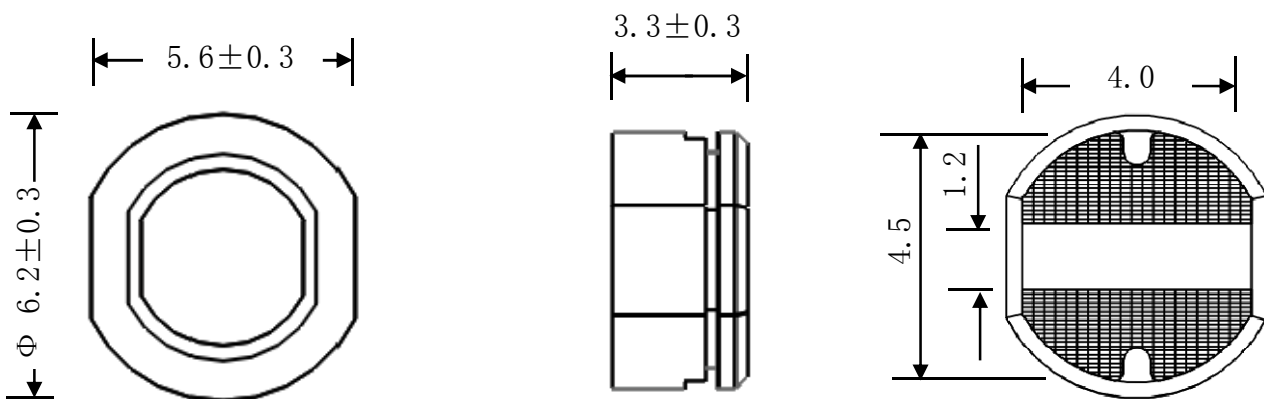

### ◆ Land Pattern (mm)

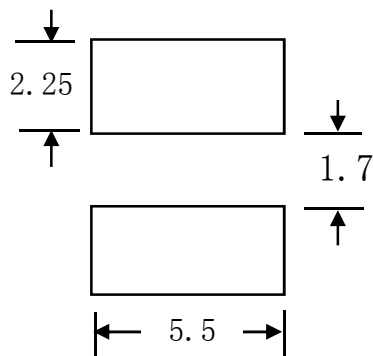

## Type:SDR63B

## ◆ Specification

Suntek Part Number	System code	Stamp	Inductance (μH)	D.C.R.(Ω) Max. (at20℃)	Rated Current (A)	S.R.F. (MHz)(TYP.)
			(at2.52MHz)			
SDR63B-100M□		A	10±20%	0.14	1.00	35.30
SDR63B-120M□		B	12±20%	0.16	0.94	32.20
SDR63B-150M□		C	15±20%	0.18	0.86	29.30
SDR63B-180M□		D	18±20%	0.25	0.78	26.70
SDR63B-220M□		E	22±20%	0.32	0.76	23.10
SDR63B-270M□		F	27±20%	0.36	0.64	20.80
SDR63B-330L□		G	33±15%	0.41	0.61	18.20
SDR63B-390L□		H	39±15%	0.47	0.53	17.00
SDR63B-470L□		J	47±15%	0.51	0.50	15.30
SDR63B-560L□		K	56±15%	0.72	0.46	14.10
SDR63B-680L□		L	68±15%	0.82	0.42	12.10

## ※Description of Part Name

SDR63B-100M□

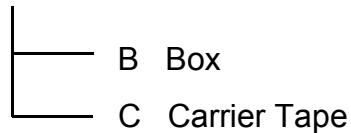

1. Inductance Measuring Frequency: 10μH~82μH;at2.52MHz

100μH~560μH;at 1 KHz

 2. Rated current: The DC current at which the inductance decreases to 90 % of it's initial value or when  $\Delta t=40^{\circ}\text{C}$ , whichever is lower ( $T_a=20^{\circ}\text{C}$ ).