

Type:SDR63

◆ Product Description

- 6.5×5.9mm Max.(L×W),3.6mm Max. Height.
- Inductance Range: 10~100μH
- Rated current range: 0.30~0.8A
- In addition to the standards versions shown here, custom inductors are also available to meet your exact requirements.

◆ Feature

- Magnetically shielded construction.
- Ideally used in Notebook PC,LCD TV,HDD,Game machine,DSC/DVC,etc as DC-DC Converter inductors.
- RoHS Compliance.

◆ Application

- Notebook PC
- HDD
- Game machine
- DSC/DVC
- LCD TV
- DC/DC converters, etc

◆ Dimensions(mm)

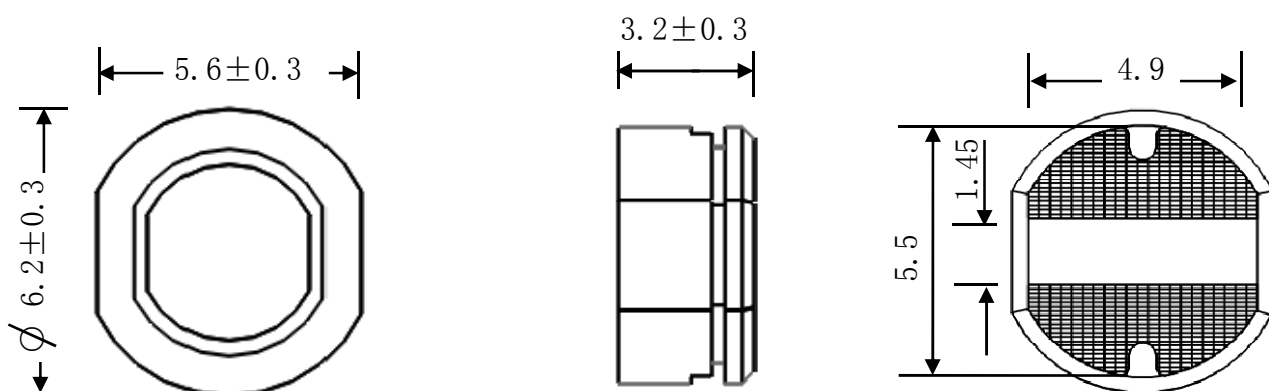

◆ Land Pattern (mm)

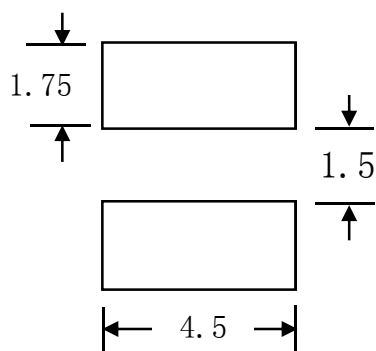

Type:SDR63
◆ Specification

Suntek Part Number	System code	Stamp	Inductance (μ H)	D.C.R.(Ω) Max. (at20℃)	Rated Current (A)	S.R.F. (MHz)(TYP.)
SDR63-100M□		A	10 \pm 20%	0.13	0.80	37.70
SDR63-120M□		B	12 \pm 20%	0.14	0.74	31.70
SDR63-150M□		C	15 \pm 20%	0.15	0.70	28.90
SDR63-180M□		D	18 \pm 20%	0.18	0.64	26.70
SDR63-220M□		E	22 \pm 20%	0.25	0.62	23.70
SDR63-270M□		F	27 \pm 20%	0.34	0.57	18.90
SDR63-330L□		G	33 \pm 15%	0.37	0.52	17.00
SDR63-390L□		H	39 \pm 15%	0.39	0.45	16.60
SDR63-470L□		J	47 \pm 15%	0.43	0.40	16.20
SDR63-560L□		K	56 \pm 15%	0.50	0.37	13.80
SDR63-680L□		L	68 \pm 15%	0.53	0.35	13.10
SDR63-820L□		M	82 \pm 15%	0.75	0.32	11.80
SDR63-101K□		N	100 \pm 10%	0.85	0.30	11.10

※Description of Part Name

SDR63-100M□

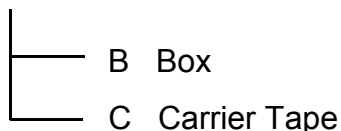
 1. Inductance Measuring Frequency: 10 μ H \sim 82 μ H; at 2.52MHz

 100 μ H \sim 560 μ H; at 1 KHz

 2. Rated current: The D.C. current at which the inductance decreases to 80% of it's nominal value or when $\Delta t=40^{\circ}\text{C}$, whichever is lower ($T_a=20^{\circ}\text{C}$).