

Type:SDGA

◆ Product Description

- Shape and dimensions: see details
- Impedance:50.0 Ω
- In addition to the standards versions shown here,
custom inductors are also available to meet your exact requirements.

◆ Feature

- Compact size
- Low RL ,low axial radio,low profile
- Built-in antenna with high gain
- Customization available

◆ Application

- Bluetooth ,Wireless LAN,Mobile TV
- Home RF system,etc

◆ Dimensions (mm)

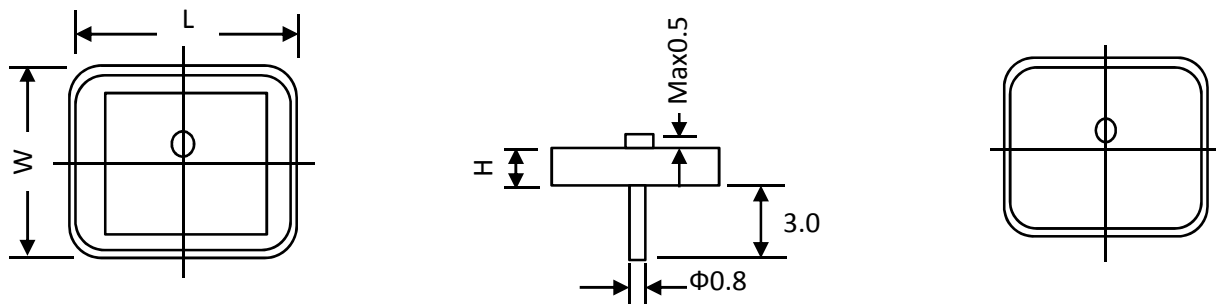

Type	L	W	H
SDGA254	25.0±0.2	25.0±0.2	4.0±0.1
SDGA252	25.0±0.2	25.0±0.2	2.0±0.1
SDGA184	18.0±0.2	18.0±0.2	4.0±0.1
SDGA182	18.0±0.2	18.0±0.2	2.0±0.1
SDGA154	15.0±0.2	15.0±0.2	4.0±0.1
SDGA152	15.0±0.2	15.0±0.2	2.0±0.1
SDGA134	12.8±0.1	12.8±0.1	4.0±0.1
SDGA124	12.0±0.1	12.0±0.1	4.0±0.1

Type:SDGA

◆ Evaluation board

Suntek Part Number	Ground Plane(mm ²)
SDGA124R1G57A01	15x15
SDGA134R1G57B01	13x13
SDGA152R1G57A01	50x50
SDGA154R1G61B01	15x15
SDGA154R1G61B02	30x30
SDGA154R1G61B03	50x50
SDGA182R1G57A01	50x50
SDGA184R1G57A01	18x18
SDGA184R2G45A01	70x50
SDGA252R1G57A01	50x50
SDGA254R1G57A01	70x70
SDGA254R2G45A01	70x70

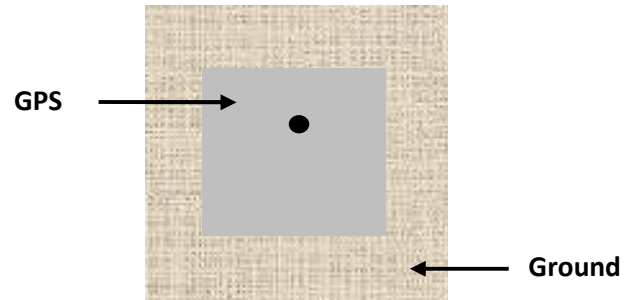

◆ Specification

Suntek Part Number	System Code	Center Frequency(MHz)	Bandwidth h (MHz)	V.S.W. R(Max)	Gain (Typ.) (dBi)	Axial Ratio (dB)	Polarization	Impedance (Ω)
SDGA124R1G57A01		1575±2	5	1.5	1	2.5	RHCP	50
SDGA134R1G57B01		1575±2	5	2	1	2.5	RHCP	50
SDGA152R1G57A01		1580±2	6	2	1	2.5	RHCP	50
SDGA154R1G61B01		1610±2	7	2	1	2.5	RHCP	50
SDGA154R1G61B02		1610±2	7	2	1	2.5	RHCP	50
SDGA154R1G61B03		1606±2	7	2	1	2.5	RHCP	50
SDGA182R1G57A01		1575±2	7	2	1	2.5	RHCP	50
SDGA184R1G57A01		1575±2	8	2	1.5	2.5	RHCP	50
SDGA184R2G45A01		2450±4	45	1.5	2	3	RHCP	50
SDGA252R1G57A01		1580±2	8	2	2	2.5	RHCP	50
SDGA254R1G57A01		1580±2	9	2	2.5	2.5	RHCP	50
SDGA254R2G45A01		2450±4	30	1.5	2	3	RHCP	50

※Description of Part Name

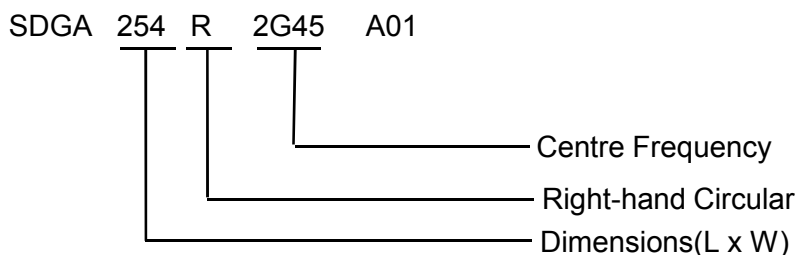

Note:

1. Operating Temperature is -40℃~+85℃.
2. Frequency will be changed with layout of PCB. Please contact us for appropriate design.