

## Type:SHCKFR88

## ◆ Product Description

- 8.2×8.2mm Max.(L×W),9.0mm Max. Height.
- Inductance Range: 0.10~180.0 μH
- In addition to the standards versions shown here,
- custom inductors are also available to meet your exact requirements.

## ◆ Feature

- Available in magnetically shielded
- Low DC resistance,Suitable for large currents
- Ideal for a variety of DC-DC converter inductor applications.

## ◆ Application

- Power supply for VTRS and ADSL.
- OA equipment,LCD televisions,PC computer.
- Portable communication equipment
- DC-DC Converters,etc

## ◆ Dimensions (mm)

Fig1.

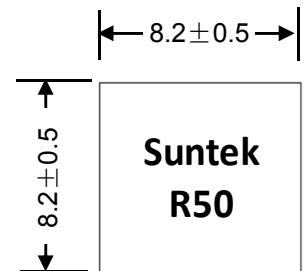
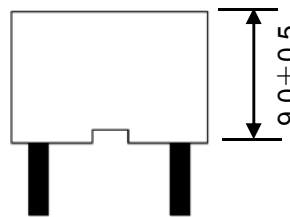
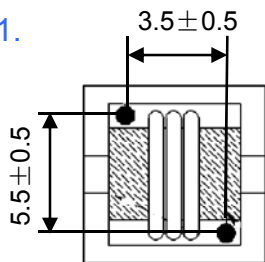
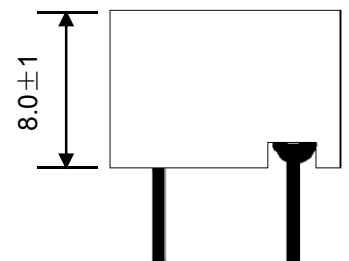
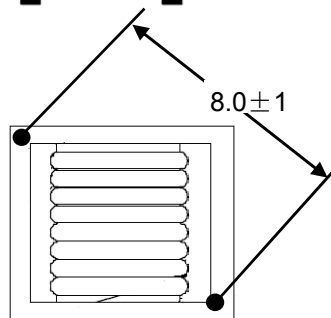
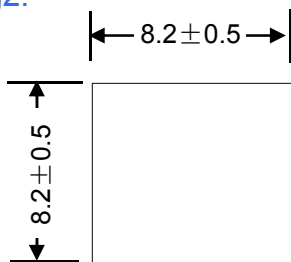
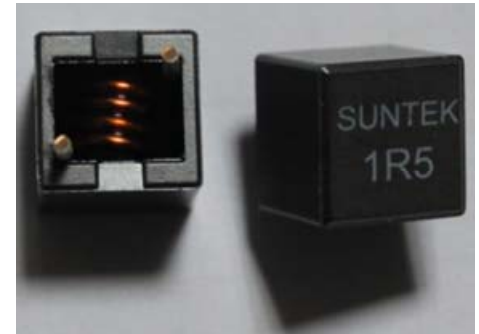
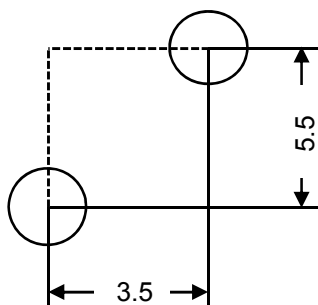

Fig2.



## ◆ Land Pattern (mm)



## Type:SHCK88FR

## ◆ Specification

Suntek Part Number	System code	Inductance (μH)±20%	DC Resistance (mΩ)Max.	Saturation Rated Current (A)	Temperature Rise Rated Current (A)	Fig No.
SHCK88FR-R10M		0.10	0.8	52	45	1
SHCK88FR-R27M		0.27	1.2	48	42	1
SHCK88FR-R40M		0.40	1.2	33	30	1
SHCK88FR-R50M		0.50	1.5	28	25	1
SHCK88FR-R60M		0.60	2.0	26	25	1
SHCK88FR-R80M		0.80	2.0	24	22	1
SHCK88FR-1R8M		1.80	4.5	10	8	1
SHCK88FR-5R6M		5.60	20	7	6	2
SHCK88FR-6R8M		6.80	20	6	5	2
SHCK88FR-100M		10.0	21	4.5	4	2
SHCK88FR-150M		15.0	65	4.2	3.8	2
SHCK88FR-220M		22.0	75	4	3.5	2
SHCK88FR-330M		33.0	110	3.2	2.8	2
SHCK88FR-560M		56.0	140	2.2	1.7	2
SHCK88FR-680M		82.0	185	1.7	1.4	2
SHCK88FR-121M		120.0	220	1.5	1.1	2
SHCK88FR-151M		150.0	290	1.4	1.0	2
SHCK88FR-181M		180.0	350	1.3	0.9	2

## ※Description of Part Name

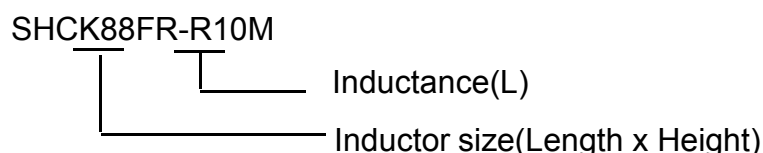

## Note:

1. Saturation Rated Current: The current when the inductance becomes 35% lower than its nominal value.(Ta=20°C)
2. Temperature Rise Current: The actual current when temperature of coil becomes ΔT=40°C.(Ta=20°C)
3. Inductance tested at 100KHz/1.0Vrms.